



REGISTERED SURVEYOR'S CERTIFICATION

Saunders Havill Group Pty Ltd, Registered Surveyor, hereby certify that the vertical and horizontal locations and dimensions shown on this plan are a true and correct record and were located by survey.

Authorised Signatory: *[Signature]* Reg. Surveyor No. 4611 Date: 14/5/21

OW/131/2020
AS CONSTRUCTED
REFERENCE SET ONLY
 REFER TO SURVEYORS AS
 CONSTRUCTED PLANS FOR FINAL LEVELS
 AND CONSTRUCTED INFORMATION

ENGINEER'S CERTIFICATION - LCC REF. OW/131/2020

I, PETER INGERMAN
 being a Consulting Engineer and duly authorised representative of:
 EMPOWER ENGINEERS AND PROJECT MANAGERS
 hereby:-
 # certify the information contained in this drawing is generally in accordance with the approved design and is an accurate "as constructed" representation of the works;
 # accept responsibility for the "as constructed" information contained in this drawing; and
 # acknowledge the "as constructed" information contained in the drawing may be relied on by the LOGAN CITY COUNCIL and others.
 Certification for Stage 2 by *[Signature]* on 17/05/21
 For: EMPOWER ENGINEERS AND PROJECT MANAGERS RPEQ 9424

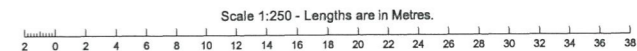

saunders havill group
 Saunders Havill Group Pty Ltd ABN 24 144 972 949
 Brisbane • Springfield • Rockhampton
 head office 9 Thompson St Bowen Hills Q 4006
 phone 1300 123 SHG web www.saundershavill.com
 ■ surveying ■ town planning ■ urban design ■ environmental management ■ landscape architecture

No.	Drawn	Date	Description	Checked
A	JTC	14.05.2021	Original Issue	SB
ISSUES				

Plan of **AS CONSTRUCTED**
STORMWATER DRAINAGE - KEY MAP

Project **THE BANKS - STAGE 2**

Client **URBEX PTY LTD**

Surveyed	Date	Lot Description Lots 36-59, 64-83, 176-186 & 188-193 on SP313772
NC	DEC 2020	
Level Datum: AHD der.		
Origin of Levels: PM130385		
RL of Origin: RL15.546		
Locality: Logan Reserve		Local Government: Logan City
Dwg No. 8131 S 49 A AC		

■ **surveying** SHEET 1 OF 4

Scale @A1 1:250
 @A3 1:500

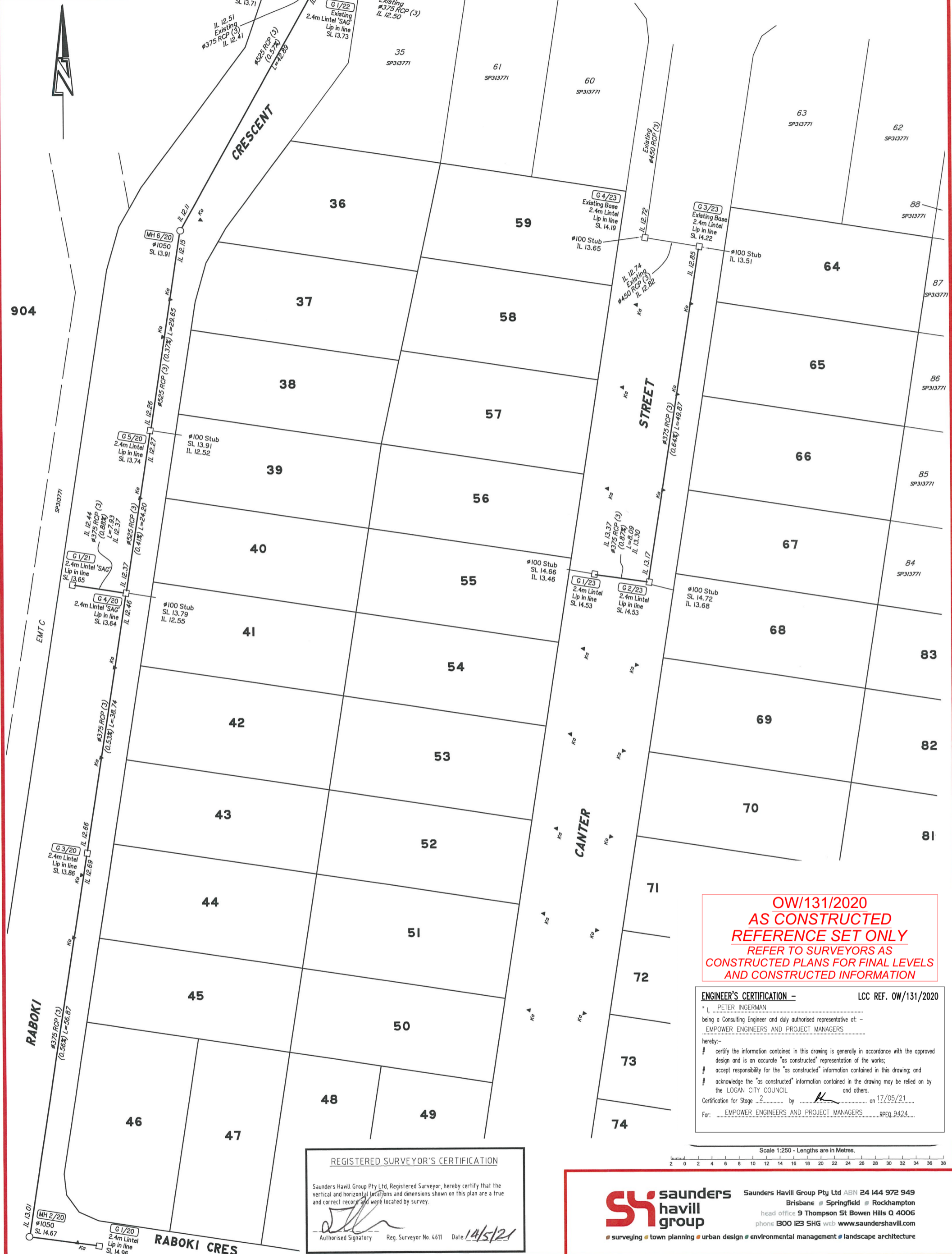

**OW/131/2020
AS CONSTRUCTED
REFERENCE SET ONLY**
REFER TO SURVEYORS AS
CONSTRUCTED PLANS FOR FINAL LEVELS
AND CONSTRUCTED INFORMATION

ENGINEER'S CERTIFICATION - LCC REF. OW/131/2020
 PETER INGERMAN
 being a Consulting Engineer and duly authorised representative of: -
 EMPOWER ENGINEERS AND PROJECT MANAGERS
 hereby:-
 # certify the information contained in this drawing is generally in accordance with the approved design and is an accurate "as constructed" representation of the works;
 # accept responsibility for the "as constructed" information contained in this drawing; and
 # acknowledge the "as constructed" information contained in the drawing may be relied on by the LOGAN CITY COUNCIL and others.
 Certification for Stage 2 by *H* on 17/05/21
 For: EMPOWER ENGINEERS AND PROJECT MANAGERS RPEQ 9424

REGISTERED SURVEYOR'S CERTIFICATION
 Saunders Havill Group Pty Ltd, Registered Surveyor, hereby certify that the vertical and horizontal locations and dimensions shown on this plan are a true and correct record and were located by survey.
[Signature]
 Authorised Signatory Reg. Surveyor No. 4611 Date: 14/5/21

Scale 1:250 - Lengths are in Metres.
 2 0 2 4 6 8 10 12 14 16 18 20 22 24 26 28 30 32 34 36 38

SH saunders havill group Saunders Havill Group Pty Ltd ABN 24 144 972 949
 Brisbane • Springfield • Rockhampton
 head office 9 Thompson St Bowen Hills Q 4006
 phone 1300 123 SHG web www.saundershavill.com
 • surveying • town planning • urban design • environmental management • landscape architecture

No.	Drawn	Date	Description	Checked
A	JTC	14.05.2021	Original Issue	SB

**AS CONSTRUCTED
STORMWATER DRAINAGE**

Project: **THE BANKS - STAGE 2**

Client: **URBEX PTY LTD**

Surveyed	Date	Lot Description
NC	DEC 2020	
Level Datum: AHD der.		Lots 36-59, 64-83, 176-186 & 188-193 on SP313772 Locality: Logan Reserve Local Government: Logan City
Origin of Levels: PM130385 RL of Origin: RL15.546		

surveying SHEET 2 OF 4

Scale @A1 1:250
@A3 1:500

Dwg No. **8131 S 49 AC A**



**OW/131/2020
AS CONSTRUCTED
REFERENCE SET ONLY**
REFER TO SURVEYORS AS
CONSTRUCTED PLANS FOR FINAL LEVELS
AND CONSTRUCTED INFORMATION

ENGINEER'S CERTIFICATION - LCC REF. OW/131/2020
I, PETER INGERMAN
being a Consulting Engineer and duly authorised representative of: -
EMPOWER ENGINEERS AND PROJECT MANAGERS
hereby:-
certify the information contained in this drawing is generally in accordance with the approved design and is an accurate "as constructed" representation of the works;
accept responsibility for the "as constructed" information contained in this drawing; and
acknowledge the "as constructed" information contained in the drawing may be relied on by the LOGAN CITY COUNCIL and others.
Certification for Stage 2 by [Signature] on 17/05/21
For: EMPOWER ENGINEERS AND PROJECT MANAGERS RPEQ 9424

REGISTERED SURVEYOR'S CERTIFICATION
Saunders Havill Group Pty Ltd, Registered Surveyor, hereby certify that the vertical and horizontal locations and dimensions shown on this plan are a true and correct record and were located by survey.
[Signature]
Authorised Signatory Reg. Surveyor No. 4611 Date 14/5/21

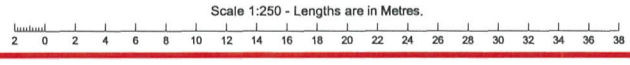

SH saunders havill group
Saunders Havill Group Pty Ltd ABN 24 144 972 949
Brisbane • Springfield • Rockhampton
head office 9 Thompson St Bowen Hills Q 4006
phone 1300 123 5HG web www.saundershavill.com
surveying # town planning # urban design # environmental management # landscape architecture

No.	Drawn	Date	Description	Checked
A	JTC	14.05.2021	Original Issue	SB

Plan of **AS CONSTRUCTED STORMWATER DRAINAGE**
Project **THE BANKS - STAGE 2**
Client **URBEX PTY LTD**

Surveyed NC Date DEC 2020
Level Datum: AHD der.
Origin of Levels: PM130385
RL of Origin: RL15.546

Lot Description
Lots 36-59, 64-83, 176-186 & 188-193 on SP313772
Locality: Logan Reserve
Local Government: Logan City
Scale @A1 1:250
@A3 1:500
Dwg No. **8131 S 49 AC A**



REGISTERED SURVEYOR'S CERTIFICATION

Saunders Havill Group Pty Ltd, Registered Surveyor, hereby certify that the vertical and horizontal locations and dimensions shown on this plan are a true and correct record and were located by survey.

Authorised Signatory: *[Signature]* Reg. Surveyor No. 4611 Date: 14/5/21

OW/131/2020
AS CONSTRUCTED
REFERENCE SET ONLY
 REFER TO SURVEYORS AS
 CONSTRUCTED PLANS FOR FINAL LEVELS
 AND CONSTRUCTED INFORMATION

ENGINEER'S CERTIFICATION - LCC REF. OW/131/2020

I, PETER INCERMAN
 being a Consulting Engineer and duly authorised representative of:
 EMPOWER ENGINEERS AND PROJECT MANAGERS
 hereby:-
 # certify the information contained in this drawing is generally in accordance with the approved design and is an accurate "as constructed" representation of the works;
 # accept responsibility for the "as constructed" information contained in this drawing; and
 # acknowledge the "as constructed" information contained in the drawing may be relied on by the LOGAN CITY COUNCIL and others.
 Certification for Stage 2 by *[Signature]* on 17/05/21
 For: EMPOWER ENGINEERS AND PROJECT MANAGERS RPEQ 9424



Scale 1:400 - Lengths are in Metres.

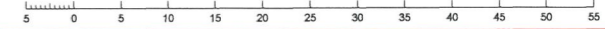

SH saunders havill group
 Saunders Havill Group Pty Ltd ABN 24 144 972 949
 Brisbane • Springfield • Rockhampton
 head office 9 Thompson St Bowen Hills Q 4006
 phone 1300 123 SHG web www.saundershavill.com
 # surveying # town planning # urban design # environmental management # landscape architecture

No.	Drawn	Date	Description	Checked
A	JTC	14.05.2021	Original Issue	SB

Plan of **AS CONSTRUCTED STORMWATER DRAINAGE**
 Project **THE BANKS - STAGE 2**
 Client **URBEX PTY LTD**

Surveyed **NC** Date **DEC 2020**
 Level Datum: **AHD der.**
 Origin of Levels: **PM130385**
 RL of Origin: **RL15.546**

Lot Description
 Lots 36-59, 64-83, 176-186 & 188-193 on SP313772
 Locality: Logan Reserve
 Local Government: Logan City

surveying SHEET 4 OF 4
 Scale @A1 1:400
 @A3 1:800
 Dwg No. **8131 S 49 A AC**